



Save
Hulme
Hippodrome

Community Conversations

Community Engagement Report
January 2025, Deb Walker

CONTENT

1. Summary
2. Project Overview
3. Community Conversations
4. Findings
5. Next Steps





Save

Hulme

Hippodrome

1. Summary

Summary

In 2024, Save Hulme Hippodrome (SHH) received a grant from Theatres Trust for a community engagement project to gather feedback on the building's future and assess local awareness of the Save Hulme Hippodrome campaign.

The project used creative, interactive methods to engage local groups, but confirming consultation sessions was challenging. A more flexible approach, including extra recruitment and extended deadlines, was needed to boost participation.

A key issue was confusion between Hulme Hippodrome and the Playhouse theatre next door, run by NIAMOS Radical Arts Group. Many people mistaking them for one, along with limited awareness of SHH.

Despite these challenges, there was widespread consensus that the building should be preserved and not repurposed for commercial use.



Summary

The renovation of the Hippodrome as a creative and cultural hub, managed by local communities, was seen as the ideal future use for the building.

Affordability and full accessibility were key priorities, along with space for local services, creative groups, and businesses.

Providing studio and retail spaces for local entrepreneurs was also seen as vital for embedding the building within the community.

To maintain ongoing community interest and ownership, this initial consultation must be further developed.

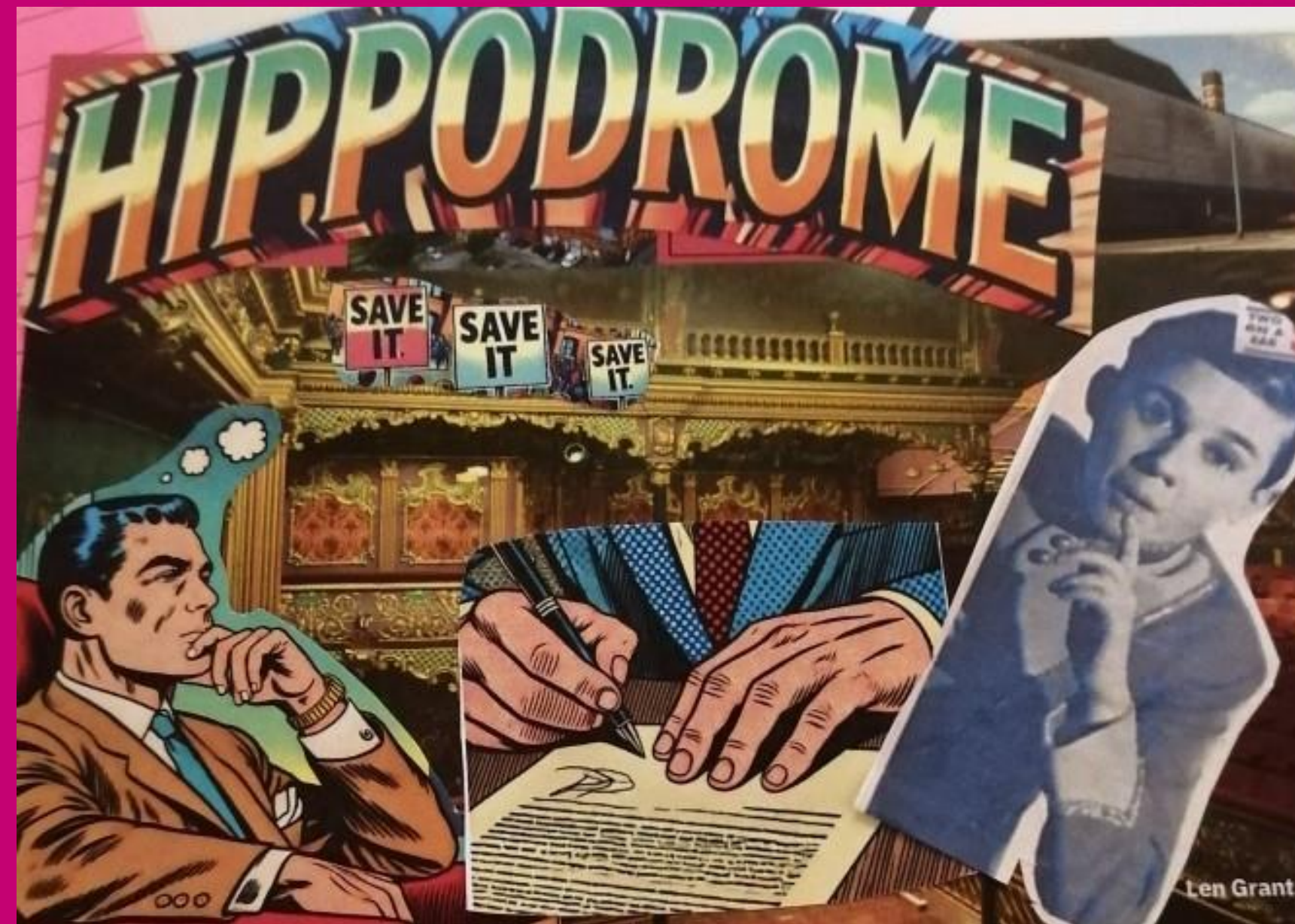

Postcard made in a creative session by local resident in support of SHH

A white graphic of a classical architectural frame, consisting of two vertical columns and a horizontal entablature with four decorative brackets. The frame encloses the text on the left.

Save

Hulme

Hippodrome

2. Project Overview

Project Brief

The core of the project was six days of “community conversations” and included informal consultation sessions, online, and phone meetings. Focused on the priority audiences identified by SHH;

- **local young adults**
- **families with children**
- **community groups not yet engaged with SHH**

Focusing on the local area radiating out from the building, including a primary school, community centres, and housing estates.

The aim was to focus on and explore what specific local communities wants and needs are for the building, and at the same time increasing their understanding and awareness of SHH and how they can actively engage with the project.



A local resident creating their postcard to the Hipp, at the tenant's group session.

Methodology

The project engaged an experienced freelance consultant to facilitate bespoke engagement opportunities with a diverse range of participants and organisations.

The consultant used their local knowledge, contacts and networks to introduce SHH and the project to local groups and organisations. To make the sessions as accessible and flexible as possible they 'piggy backed' on to regularly held sessions.

Working with the interests of the organisations a variety of engagement methods were delivered including;

- **in-depth engagement sessions with creative practitioners**
- **drop-in visits to existing events**
- **in person and digital surveying**
- **phone and online meetings**

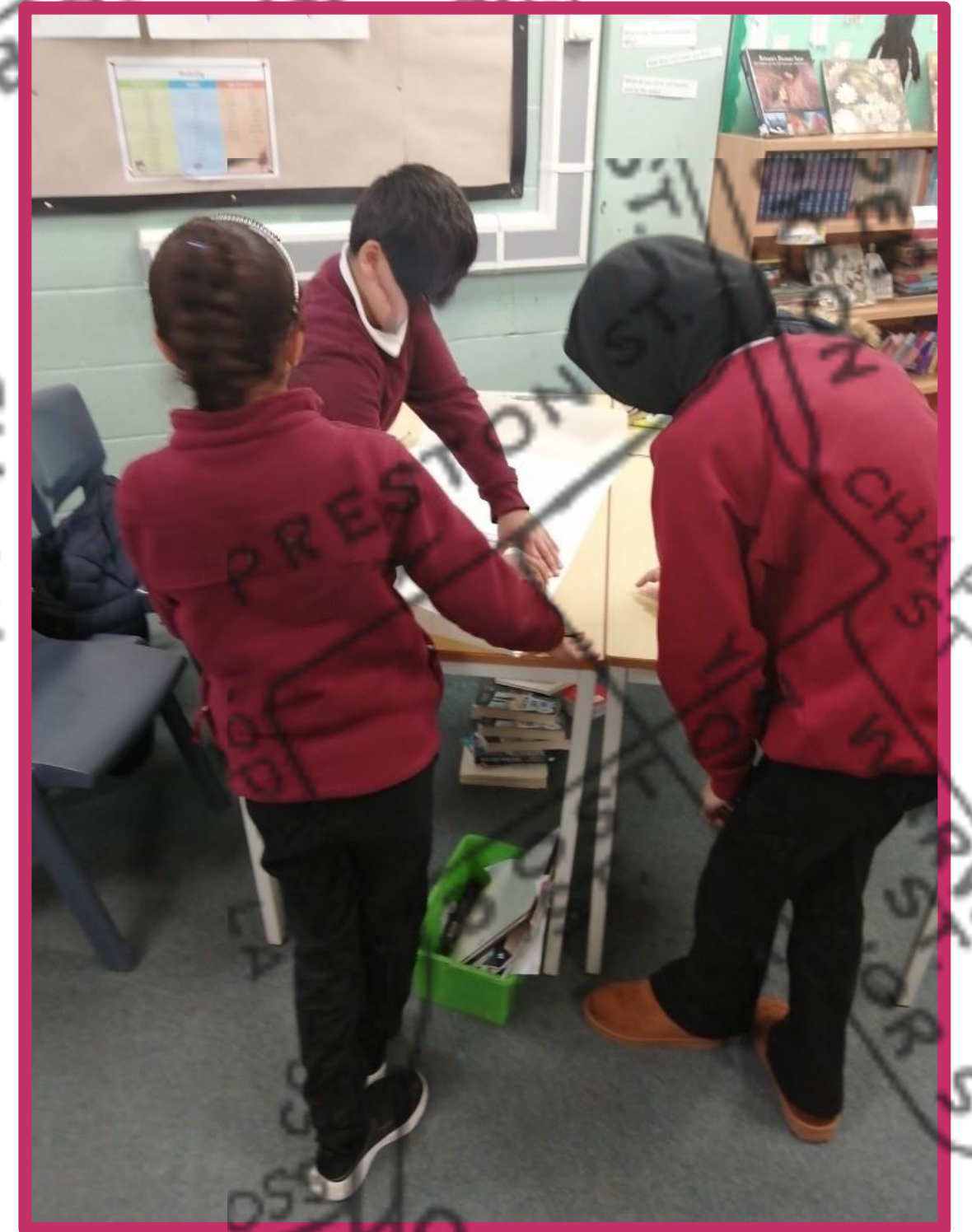

Hello

I have been invited to come along to the ----- on -----.

I would love to have a chat with you about Hulme Hippodrome, and any stories you have of the venue and what it could be in the future for everyone living and growing up in Hulme.

I'm really looking forward to meeting you soon. Tea, coffee and cakes are on me!

Deb Walker, on behalf of Save Hulme Hippodrome

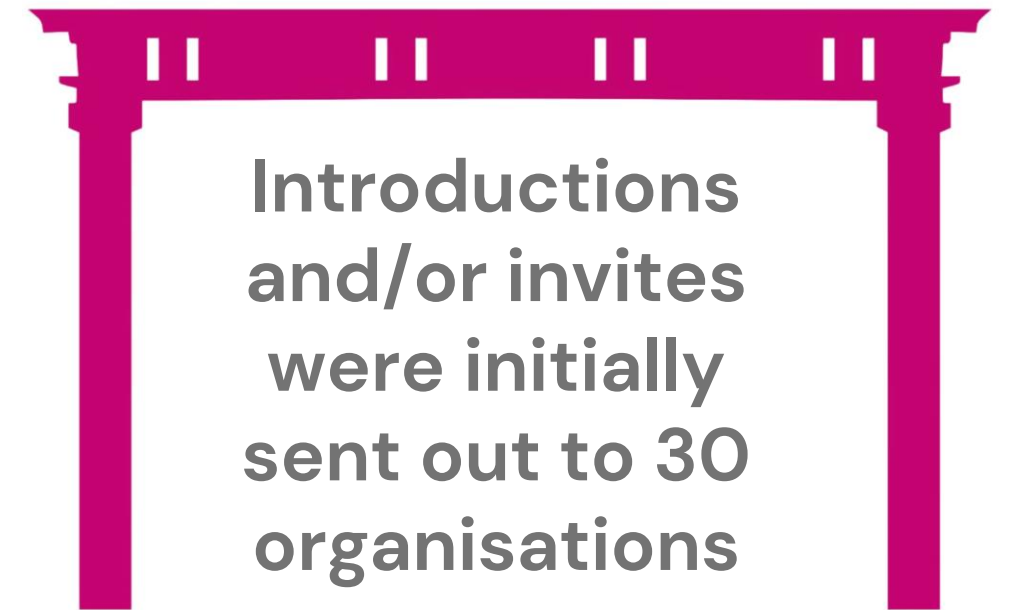
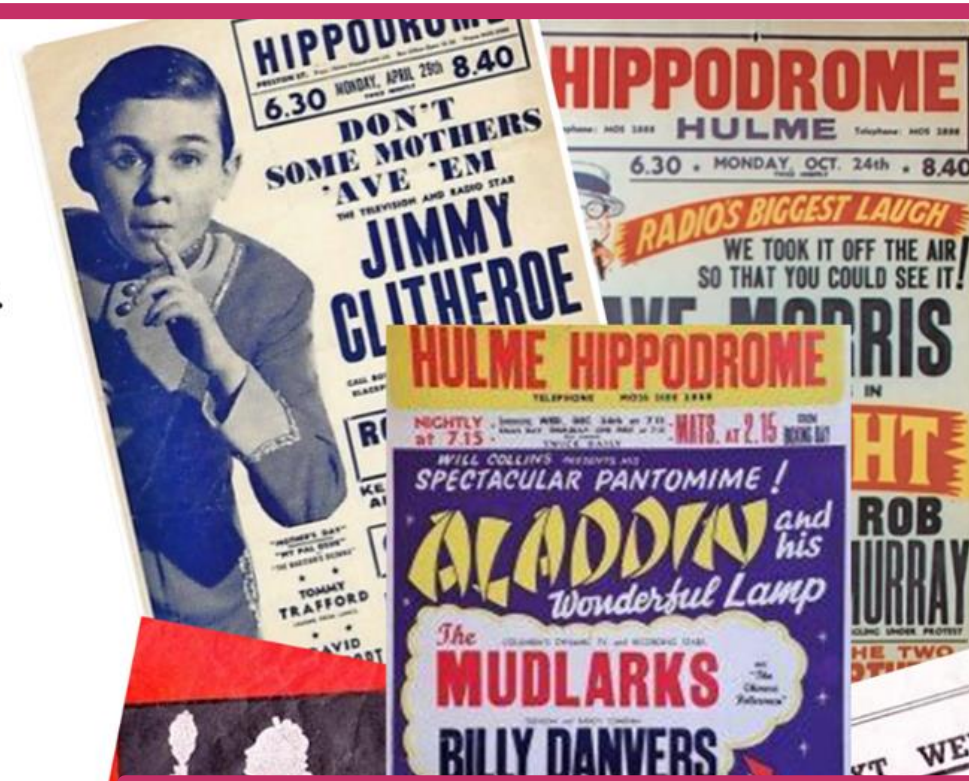

Introductions and/or invites were initially sent out to 30 organisations

A short introduction to Save Hulme Hippodrome and their community conversations project

Save Hulme Hippodrome Ltd is a non-profit community campaign group who want to save and restore Hulme Hippodrome as a community cultural hub and are keen to hear from as many local voices as possible, as they will hopefully be the future users and leaders of the venue.

There is lots more information on their website hulmehippodrome.org

My name is Deb Walker and I'm working with the Save Hulme Hipp team to find out your thoughts, ideas and dreams for this much loved local landmark. As well as updating you on the Campaign so far and how you can get involved in developing a Hulme Hipp fit for the next 100 years!

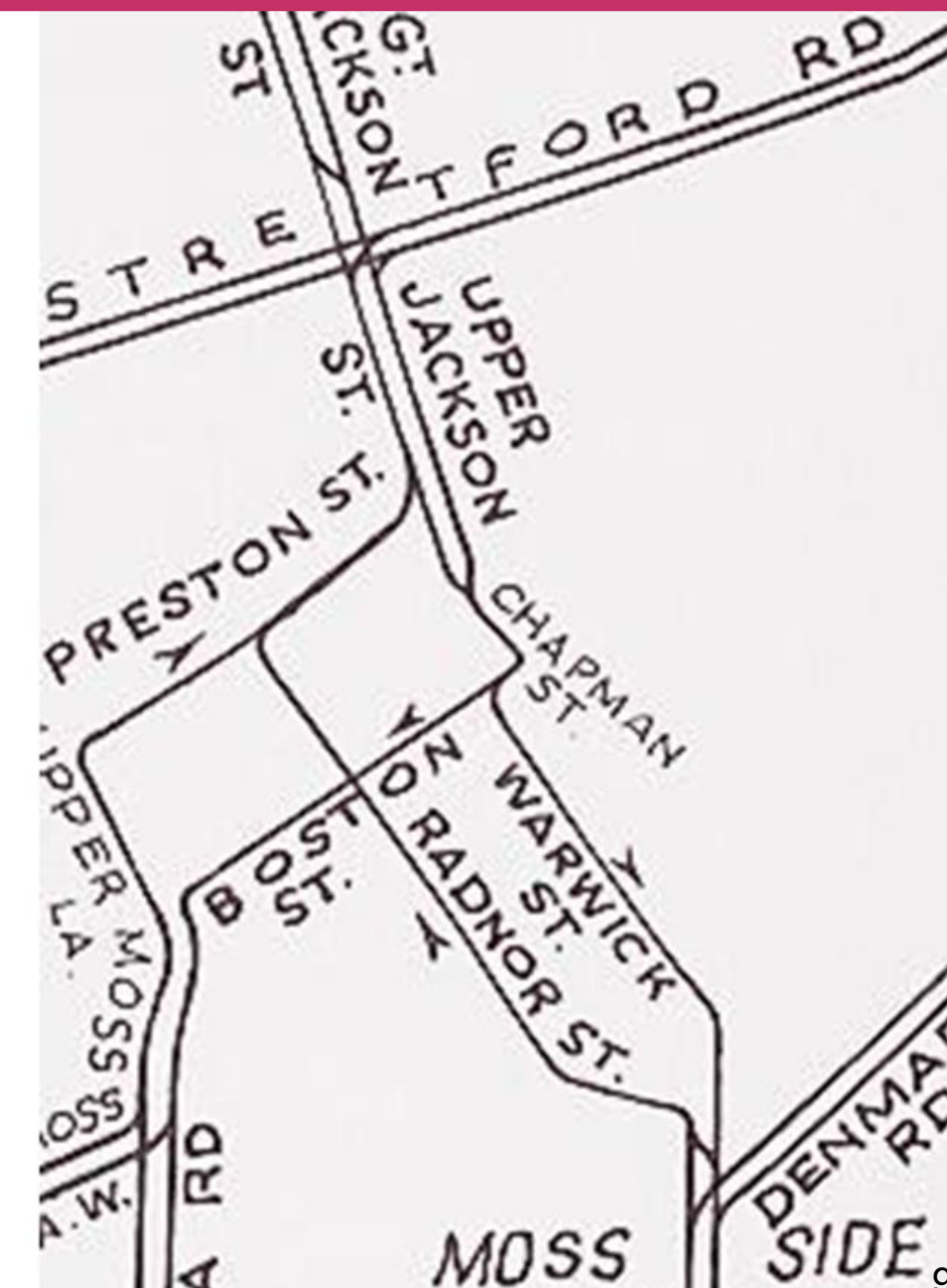

The invite template was sent to group leaders to encourage take up of the sessions. It also gave potential participants an idea of what to expect from the session.



Creative Facilitators

A key method of delivery was to include creative facilitation to reflect the creative legacy of Hulme Hippodrome, whilst boosting engagement and impact. Two in-depth sessions were led by creative practitioners, using poetry, spoken word, drawing and collage to foster a deeper engagement with the building's future. As well as providing an entertaining and engrossing session.

Griot Gabriel is a Manchester based spoken word poet.

gabriel@the-poetryplace.com

<https://www.the-poetryplace.com/>

Kate Ireland is a writer, performer and theatre maker

irelandkate9@gmail.com

Both are skilled and experienced socially engaged creative practitioners.

Manchester
City of Literature



Creative Engagement

A variety of activities and resources were utilised to provoke discussion and feedback, with a focus on visual imagery, including the building (past and present), historical posters and leaflets, and early drafts of potential future renovations.

Interactive activities were incorporated to ask questions and spark interest, encouraging participants to engage more deeply with the subject matter.

Discussions were facilitated with the aim of

- **creating awareness of Hulme Hippodrome**
- **highlighting Save Hulme Hippodrome efforts in securing ownership, funding, and resources for future plans**
- **encouraging active involvement in SHH**

Physical and printed resources were used due to limited access to technical equipment.



These three images proved the most useful at garnering engagement in the session and gaining participants awareness and interest in the future redevelopment of the Hippodrome.

As well as clearly showing the duality of the building and that NIAMOS only resided in one third of the building, the old Playhouse Theatre.

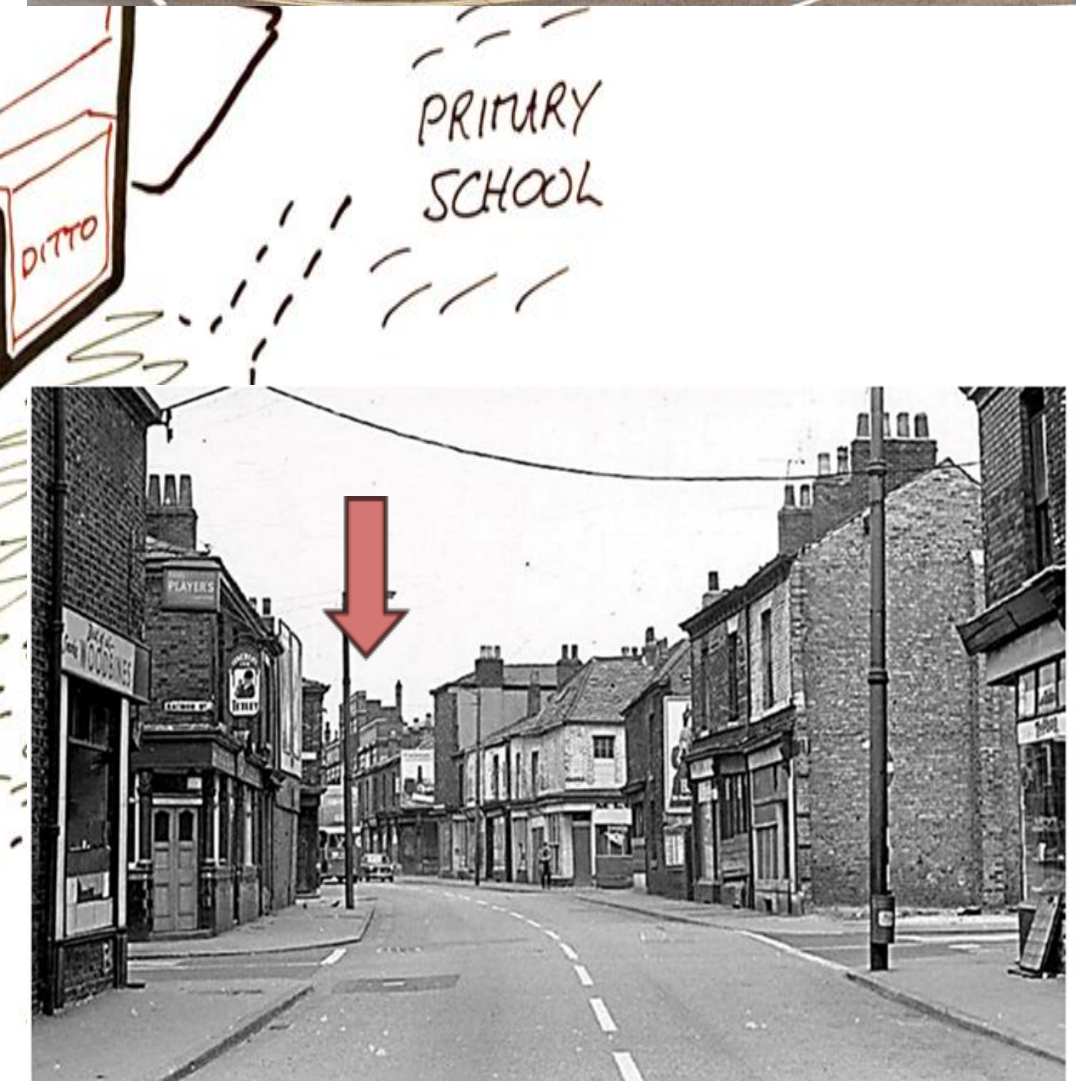
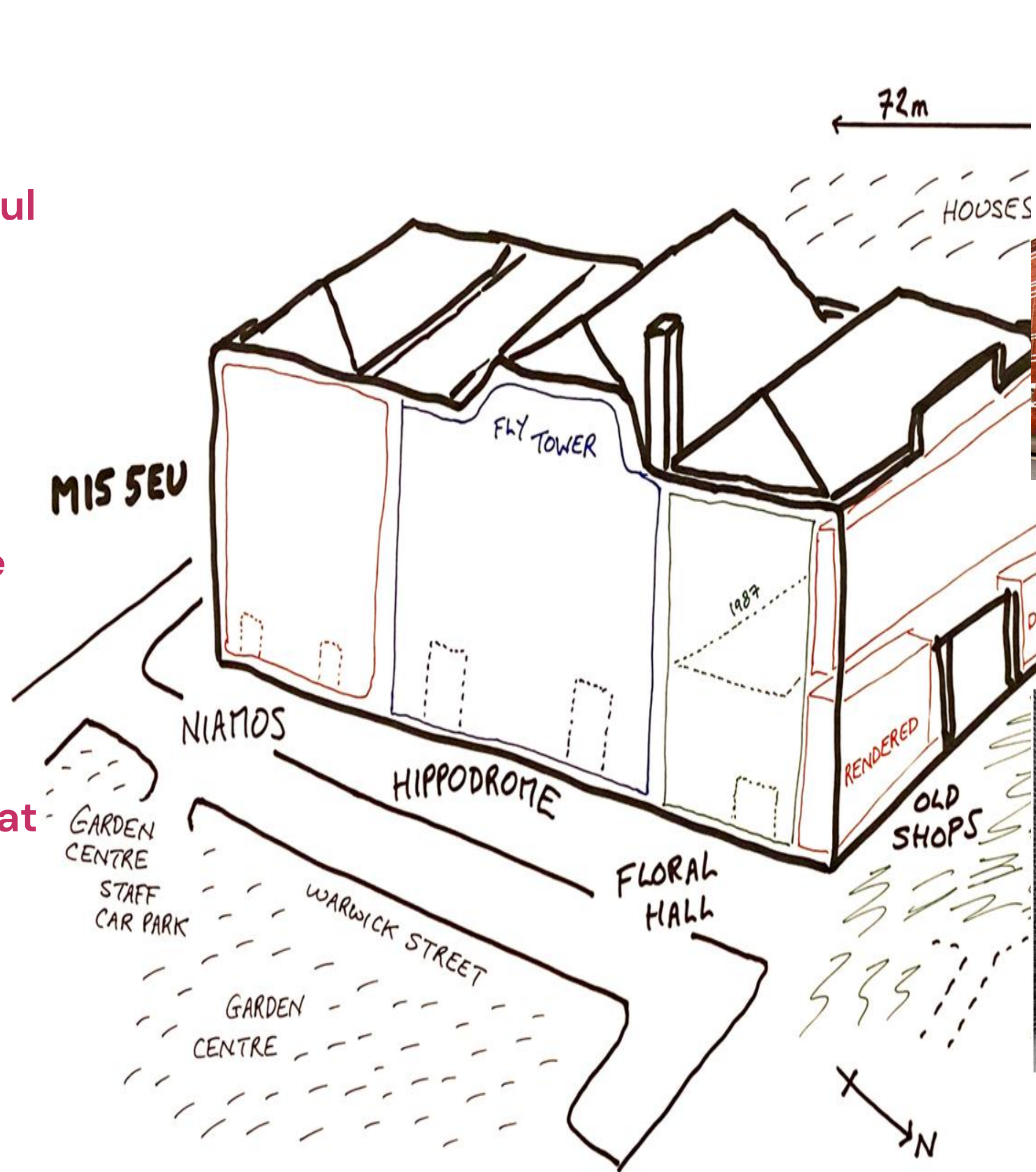

Surveying

To enhance the consultation process and capture targeted feedback, two tailored surveys were created – one for children and one for adults.

The adult survey was distributed to key local organisations via email and followed up with phone discussions to ensure deeper engagement and response.

This approach ensured that feedback was not only gathered but also actively discussed, maximizing participation and insights.

Designed by a locally based young creative to foster community partnerships and support creative development in Hulme.



Resource Development

As part of the engagement project, a series of resources were developed, which can be utilised beyond the completion of the initial project. Including;

- Display boards and banners
- Sets of past and present images of the Hippodrome
- Intro panels to the Hippodrome and SHH campaign
- Information on the viability of and draft design for building redevelopment
- Art materials for participants use
- 'Giveaways' to promote awareness of SHH campaign including;
 - postcard with SHH contact details
 - illustrated leaflet on SHH campaign so far
 - SHH stickers
 - SHH enamel badge
 - Addition of twisty pencils for school children!



'Goody Bags' were used to say thank for attending the sessions and to increase awareness of SHH. These went down well, in particular the badge and leaflet. Many participants asked for extra stickers and leaflets to give out to family and friends.

Delivery

Initial conversations with local groups generated strong interest in the sessions, but when it came time to schedule them, the pressures of "usual business" made participation difficult to confirm.

As a result, arranging the six planned sessions proved challenging, prompting a shift in approach to include surveys and phone interviews with key local organisation leads.

Flexibility was key, as many community groups had limited time or felt the project wasn't advanced enough for full engagement. The project was overseen by one key SHH board member, who reviewed the delivery plan, helped produce promotional materials, and sign off on all areas.

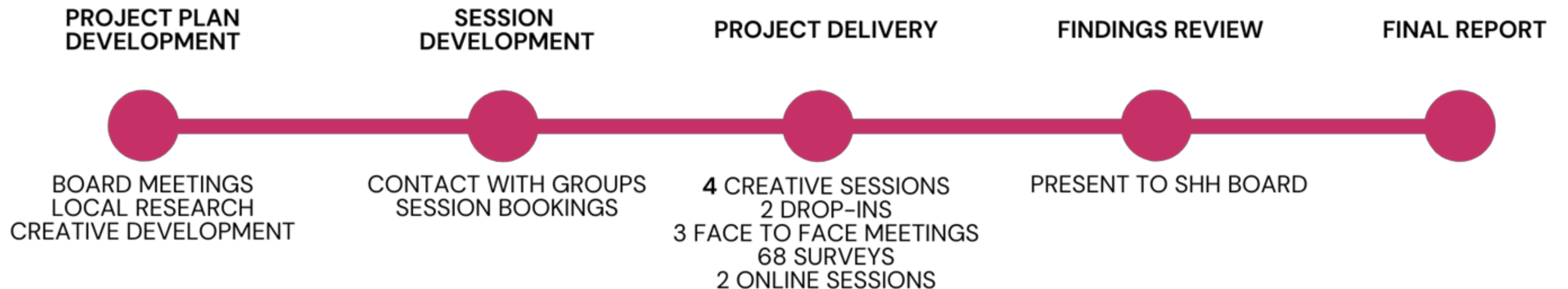

Delivery in Numbers

Key sessions included:

- **Drop-in sessions** offering informal opportunities for feedback.
- **In-depth sessions** with targeted groups such as People First tenants, primary school students and parents, facilitated by local artists and poets.
- **Questionnaires** distributed to students, staff, and local organisations to gather additional feedback,
- **Phone and online surveys** sent to local organisations like the Hulme Neighbourhood Team and Manchester Youth Justice.



Delivery – Stats

Consultation	Organisation	Group Information	Participants
Drop-in session	MCC monthly drop-in sessions for families with children with SEND needs	A half-day session. Discussions with staff, parents and volunteers	15 -20
In-depth session	People First tenants' group	3-hour session with People First wellbeing tenants' group. Delivered with local artist/writer.	7
In-depth x 2 sessions	Rolls Crescent Primary School – Yr 6 classes	Two half day sessions covering 2 classes. Delivered with local poet.	56
In-depth session	Rolls Crescent Primary Parents Group	1 hour session. Delivery of a session within a regular parents group meeting.	6
Survey	Rolls Crescent students and staff members	Teachers actively assisted their students to fill in surveys. One adult survey completed by Head of School.	68
Phone and online	Team Around the Neighbourhood Team	The organisation based survey was sent to the Team Co-ordinator to forward on to relevant staff members	2
Phone and online	Manchester Youth Justice and Remedi	The organisation based survey was emailed to a number of staff, but only Head of Service completed it via a phone call.	1
Drop-in session	NIAMOS café	2 hour session with café customers and staff member	3



Save

Hulme

Hippodrome

3. Community Conversations

Sessions in Action

All the sessions contained the following elements:

Welcome and introductions

Important to be clear of consultant's impartial role to enable participants to share their open and honest opinions

Introduction to Save Hulme Hippodrome and the progress of the campaign so far

What do they want to see and importantly not want to see happen to the building what would be their priorities for the building in the future



The tenant's group presenting their hopes and dreams for a new Hulme Hipp

Creative Conversations

The sessions, co-delivered with creative practitioners, kept participants engaged and generated valuable suggestions. At the end of both sessions, all participants expressed how much they enjoyed taking part, with adults particularly appreciating the opportunity to have their voices heard.

“A place to meet in the middle – common ground – communities can come together; their voices are heard in a non-patronising way and a place for personal development and empowerment.”

Local resident, Tenants’ group sessions October 2024



“ A new gym to keep us healthy,
A stage for singing & dancing,
A cafe to feed the locals,
Unity for all the community. ”

Poem by Year 6 student



Local residents conversations

This session took place during a regular tenants' group meeting at their local venue, with a small group of participants aged 17 to 75+.

Everyone was engaged throughout, eager to learn about the building's future and share their thoughts.

Janet, the Housing Officer, received the invite and was so intrigued that she immediately researched the building online, amazed by the wealth of information, especially the heritage. She actively participated in the session and repeatedly thanked the consultant for bringing it to her group.



Local residents conversations

What they didn't want	What they hoped for
No student /residential/office accommodation	A place to galvanise opinions as well as developing integration of different groups
No profit makers – commercial draining of community resources	Inclusivity and fair rules
No overpriced goods and services most local communities can't afford	Health and wellbeing is central ethos
Don't want cliques or only small number of people doing all the work	A place to share /exchange expertise and resources
Don't want student heavy services	Has positive, safe and fun vibes
That the local community would not be empowered fully to lead on development and management of the venue	Spaces to be creative
	Awareness of communities' spiritual connections



DEAR MANCHESTER CITY COUNCIL,
"Help we need somebody" to support us
in the saving of the hippodrome, for the mental,
physical, social & spiritual needs of the community.
The general well being of the community being
the key to unity & cooperation giving rise
to a sustainable future we can believe in.
EJL

After the introduction and a spirited discussion on the SHH campaign, the session was led by the artist, which culminated in the participants writing a postcard to the Hippodrome and what they hoped it would be like in the future.

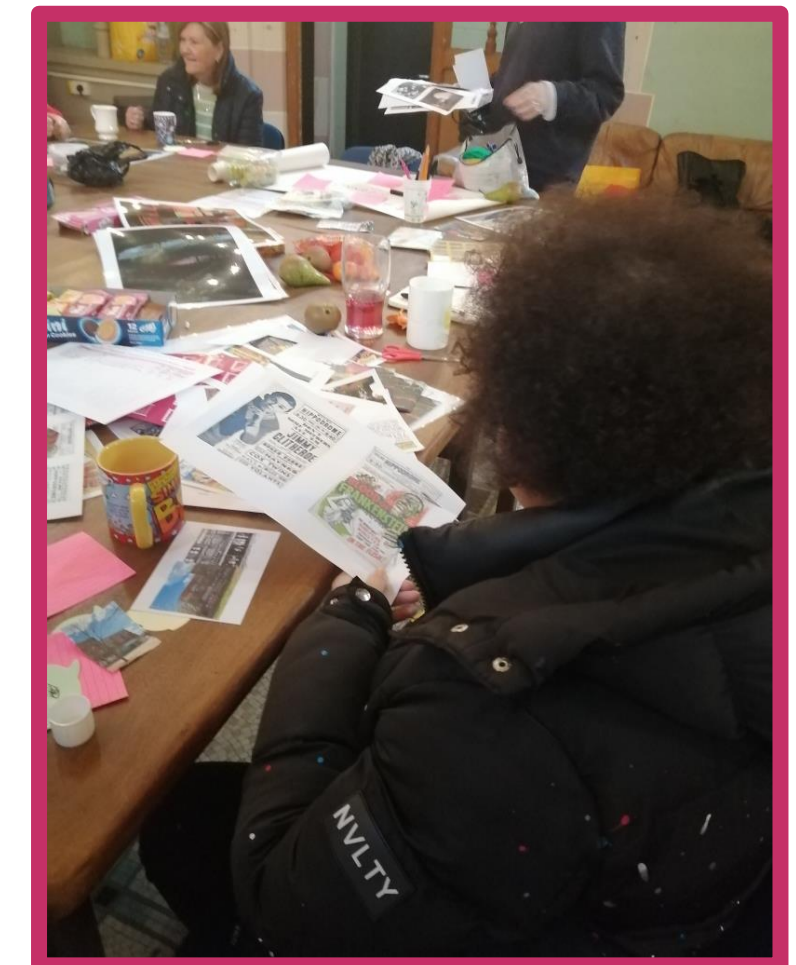

As the session concluded, each participant expressed their gratitude, thanking the consultant and artist for a wonderful experience and wishing SHH success in saving the building.

'Meeting in the middle on common ground'

I want to see the community coming together & work with others, use their voices, without patronising. We have much to offer and share.

Personal empowerment
Unity.commi. all the way Vicki X

This relaxed and collage-based activity had a member of the group fully participate, even though everyone said she never normally joined in such group work!



Postcards to Hulme Hippodrome
Creative engagement activity



School Conversations

Two sessions were held with Year 6 classes, where children worked in small groups and individually to design their ideal redeveloped Hippodrome.

Over 100 children (aged 7–10) from Rolls Crescent Primary School, overlooking the Hippodrome, participated in the sessions or completed surveys.

Although most were aware of the building, not all knew its history.

They envisioned a mix of creative and cultural activities, such as swimming pools, gaming, indoor sports, and arts and crafts, as well as performing arts and history.

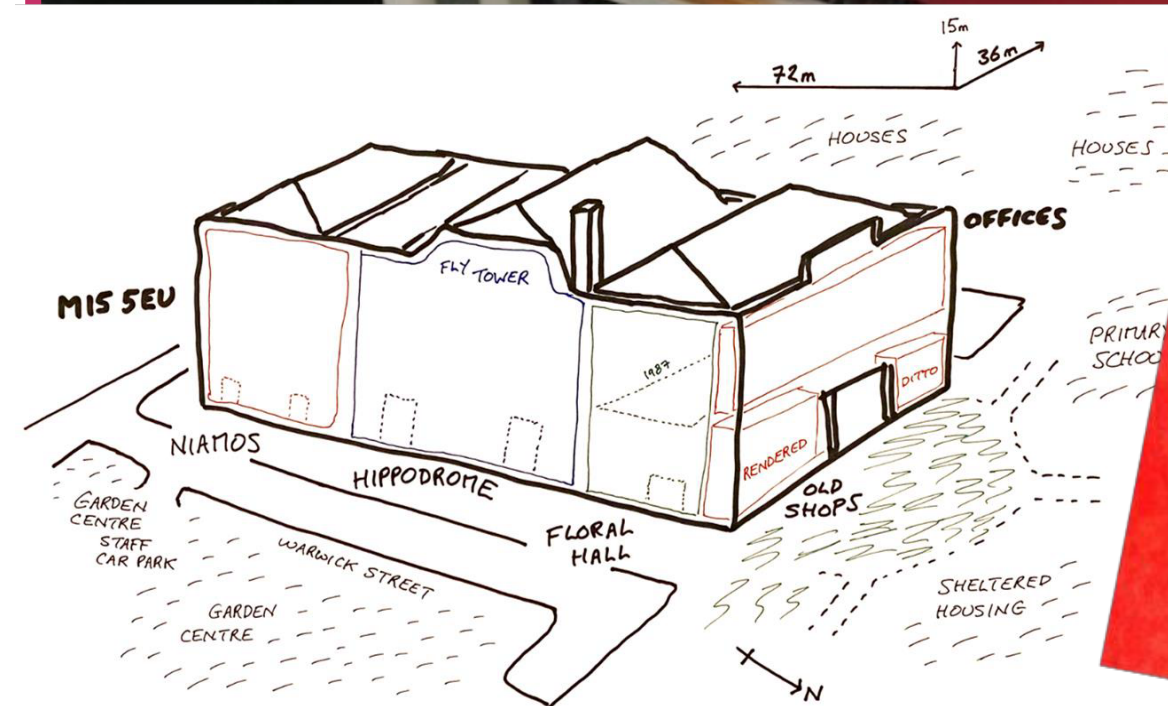

School Conversations

A number of children mentioned the need for the building to have services and clubs for children and people who need it most, from homeless and refugees to children in care. They suggested community run cafes and bakeries and free access to such things as washing machines.

One of the Year 6 classes had a whole class discussion on the importance on affordability and accessibility and that bike and buggy storage would encourage people to attend.

All agreed they wanted to try out /learn new things as well as having fun and that sports and exercise was as important as entertainment.



If I could design the Hippodrome I would:

The past of the Hippodrome was your imagination
it's like going on vacation
but the Hippodrome now needs donation
before it formation turns ~~down~~ to stagnation

If I could design a Hippodrome I would
make a art's and crafts room
where all your art's work's bloom

If I could design the Hippodrome I would: have a room filled
with art for all to enjoy. A lushes yard packed with plants around
the world. A gameing room. PS, xboxs, PCs to board games a place to sit back and
game for hours on end. Movies one after the other, goals one after the other
endless laughter for years to come so please bring back our home

If i could design the hippodrome...

it would never be abandoned or alone, if I could design the
HIPPODROME

Mysterys of artifacts will be known. If i could design

the hippodrome there will be performances an acts. If i could

Design the hippodrome everything will be back. If we could

Design the Hippodrome

Ancient history will have some \rightarrow history. We can design the

Hippodrome.

A small sample of the 'If I could design the Hippodrome' poems, produced by Year 6,
the culmination of their creative session with poet Griot Gabriel.

School Conversations – Surveys

Due to the positive response from the Year 6 sessions, both student and adult questionnaires were forwarded to the Head of School.

A total of 67 student responses (ages 6–10) and 1 staff response were received. Over 80% of the children were familiar with the building, noting that it could be seen from the school playground, and they were aware that it had previously served as a theatre before closing.

Similar to the Year 6 students, they expressed a desire for a new Hippodrome that would include a mix of leisure and community spaces for themselves, their families, and local people in need of extra support.

Popular local spots included Z Arts, Hulme Park, and other nearby parks. Many expressed a desire for more child-friendly spaces with play areas, calling for "more fun stuff and activities for kids."

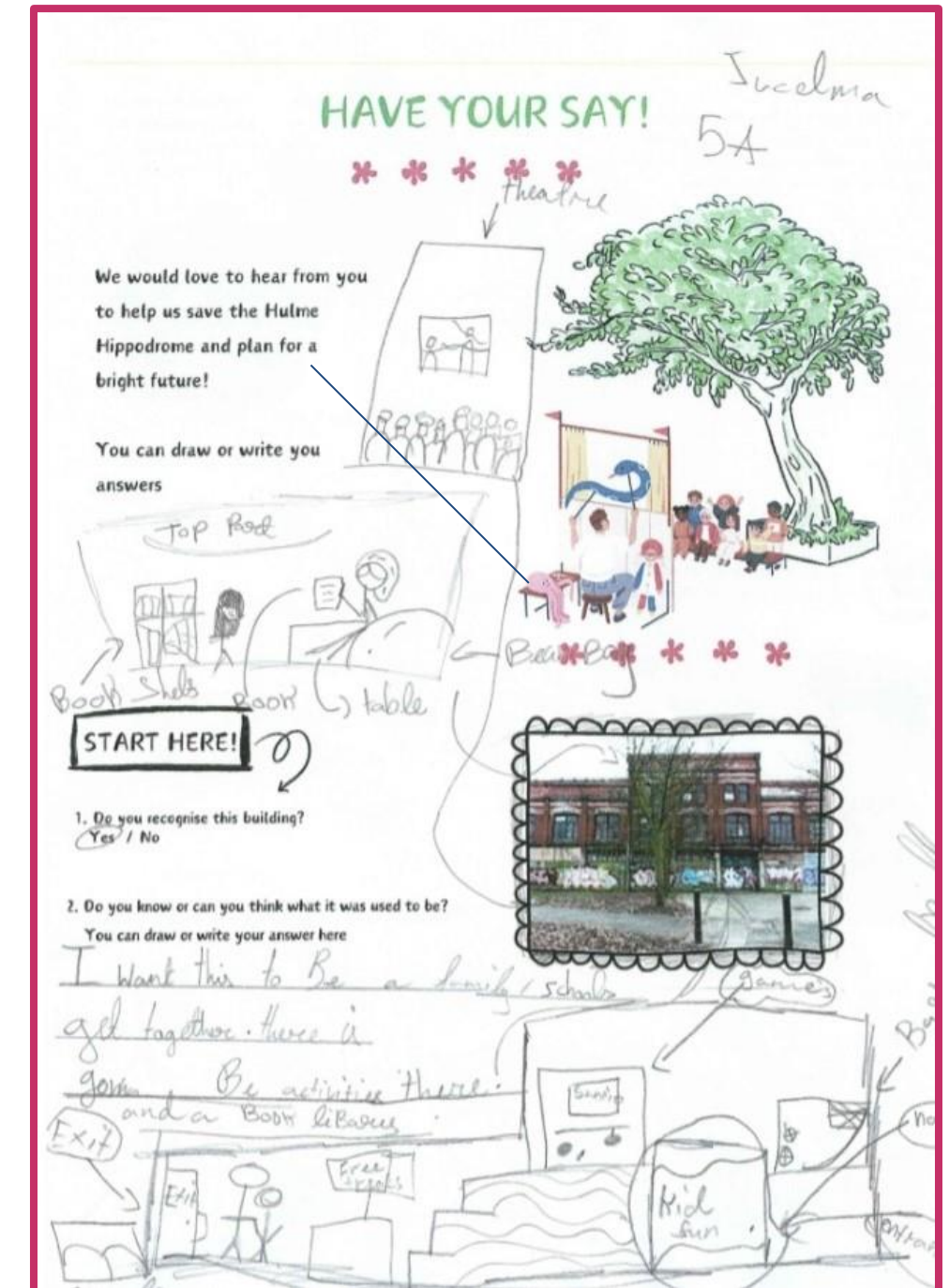

"A singing place for pop, pantomime"

"Hangout place for everyone"

"£1 tickets!"

START HERE!

1. Do you recognise this building?
Yes / No

2. Do you know or can you think what it was used to be?
You can draw or write your answer here



I used to be a church, a concert place and theatre.
It got abandoned and got old.

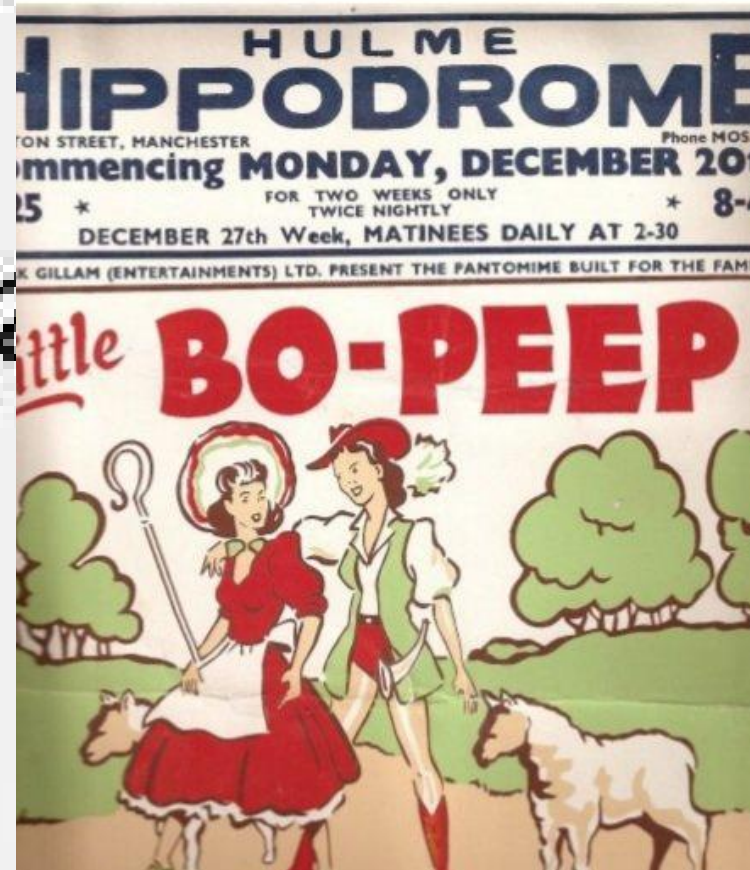

3. We are trying to buy the building, so we can open it again for everyone in Hulme - what would YOU like to see and do in the new Hippodrome?

I would like a cinema for everyone.
Maybe a place for pantomime.
Or a place for homeless people to sleep, eat.

Rolls Crescent

Keila 5A

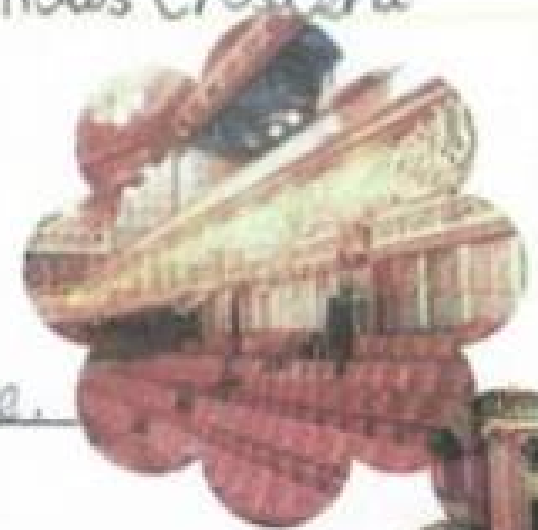

The Hulme Hippodrome began as a theatre over 120 years ago!

Parent Conversations

A session was held with a small group of parents and the school's Family Liaison Officer, who was developing and promoting the coffee mornings.

With just an hour allocated, the focus was on what they didn't want for the space and what they envisioned for its future. At the end we discussed what a new Hipp could mean for them personally.

They were fully engaged, sharing ideas enjoying one member's stories of going to the venue in her youth.

Everyone agreed the building should be renovated into a community led cultural venue.

"I would like a place that is safe and demonstrates good modelling for my son in his teenage years."

"Giving children purpose and developing their cultural identity."

"I would like to run a community dance workshop, as well as helping put on plays and performances. I could assist in teaching basic skills in English and maths, hygiene and first aid."

"I would love to be able to use my qualifications as a make up artist, share my skills and hopefully start my own business."

Parent Conversations

What they didn't want	What they did want
For it to be turned into housing (student or social)	The community should have a key role in running the venue and delivering events and activities, with local people trained to manage both the venue and its offerings.
For it to be costly to access offer/events	A safe and welcoming place for local groups to use, parent/mother and child and youth groups and a chat hub assisting with wellbeing and mental health issues
For it to become a church again	Continue the live entertainment element including film screenings
To have no community influence	Adult learning and skills offer to include activities for their children while they are in sessions. ESOL/English classes were specifically mentioned
	Include history of the Hippodrome, especially stories from people who used it/worked there
	Creative activity offer for all ages, providing well equipped studios for dance, art and drama
	Provide equipped spaces for business start-ups for local people

Drop-in Sessions: parents and carers with children who have SEND

After no success in gaining interest directly with the SEND Parents Forum, the consultant arranged to host a stall at the monthly drop-in sessions for parents/carers.

The stall engaged with parents/carers and staff from organisations supporting them. Many were unaware of Hulme Hippodrome, and those who were, didn't realise that NIAMOS and the Hippodrome were separate venues.

Everyone was eager to see the building preserved and redeveloped with a community focus, especially to provide local services for children.

“Fracturing the building doesn't help, community needs to work together to stop developer slicing and dicing.”
Early Years and Children Services staff member.



SPECIAL EDUCATIONAL NEEDS AND DISABILITIES (SEND)

LOCAL OFFER

Discover all the activities, services, advice and support offered across the city to children and young people (0-25 years) who have special educational needs or disabilities.

LOCAL OFFER WEB PAGE
www.manchester.gov.uk/sendlocaloffer

EMAIL NEWSLETTER
Regular newsletter sent twice a month.

DROP-IN SESSIONS
No need to book. Everyone welcome.

CHANGE-MAKERS
They gather and represent the views of children and young people.

SOCIAL MEDIA
@MCRLocalOffer

PARENT CARERS FORUM
Our strategic partner, gathering and representing the voice of parent carers.
[facebook.com/mpcfinfo](https://www.facebook.com/mpcfinfo)

PARENT CHAMPIONS
Offering peer-to-peer support.
[facebook.com/groups/manchesterparentchampions](https://www.facebook.com/groups/manchesterparentchampions)

AND MUCH MORE...
Call us on 0161 219 2125 or email localoffer@manchester.gov.uk

Drop-in Sessions: parents and carers with children who have SEND

Key priorities for this group were:

- A fully accessible venue addressing physical, mental health, and complex needs, as well as financial issues.
- A family hub, with regular pop-up services, stay-and-play sessions, and youth clubs, offering speech therapy, life skills, and a fun, creative environment.
- A low-cost membership for access to activities and services, along with quiet spaces and a zoned sound system.
- The need to prevent the fragmentation of the building, as it hinders community cohesion.
- Many parents saw this venue as a place for their children to socialise, build skills, and develop confidence and resilience.



A local support worker suggested that some of her service users might be interested in contributing to the renovation process, which would give them a sense of ownership and investment in the space. She also mentioned that local retired individuals in the building trade would likely be eager to help, as a way to give back to the community.

Drop-in session at NIAMOS cafe

After several phone calls, texts, and emails, the consultant suggested holding a drop-in session with residents attending their community cafe, including the Co-Director who runs the new cafe initiative.

The goal was to offer free refreshments from the cafe and discuss their thoughts on the future Hippodrome development and its connection to the NIAMOS venue.

There were only 2 customers, both very close to NIAMOS, which led to a three-way conversation which fostered positive communication, raising awareness of SHH's goals and how they align with NIAMOS, particularly in training and developing young people to deliver all aspects of live performances/events.

As with all previous sessions they wanted the Hippodrome to be redeveloped, focused on local communities creative and cultural interests, fully accessible to all. They added they wanted it to be a fully integrated space, connecting the two venues.



www.niamos.co.uk

“Be good to get round the table, on a equal footing and discuss “true intentions” and how this could help NIAMOS meet their vision of developing, improving and empowering local people.”

Co-Director, NIAMOS

NIAMOS session

This session brought forward the most radical and innovative ideas as well as looking at the building as a whole and not just the service provided within it, including:

- Incorporating technology into the structure of the building to create intuitive systems for staff, volunteers, and users, “such as screens to show where and what things need to be undertaken each day, from cleaning to event set ups.”
- Redesigning the building to lower running costs and ensure affordable maintenance.
- Enhancing energy efficiency with sustainable features, such as solar power, energy-storing dance floors, and green roofs and walls.
- Establishing a Life Experience Centre to build self-confidence, resilience and support mental well-being.
- Providing a safe, welcoming space for all, particularly young people.
- Partnering with events/creative venues including NIAMOS to share skills training, practical experience, and mentoring.
- Using "limbic engineering" to engage all senses in learning.
- Creating a space for crafting, repairing, and equipment swapping.
- Offering a neutral space for young people to discuss challenges (e.g., gangs, low skills, employment) and receive support.

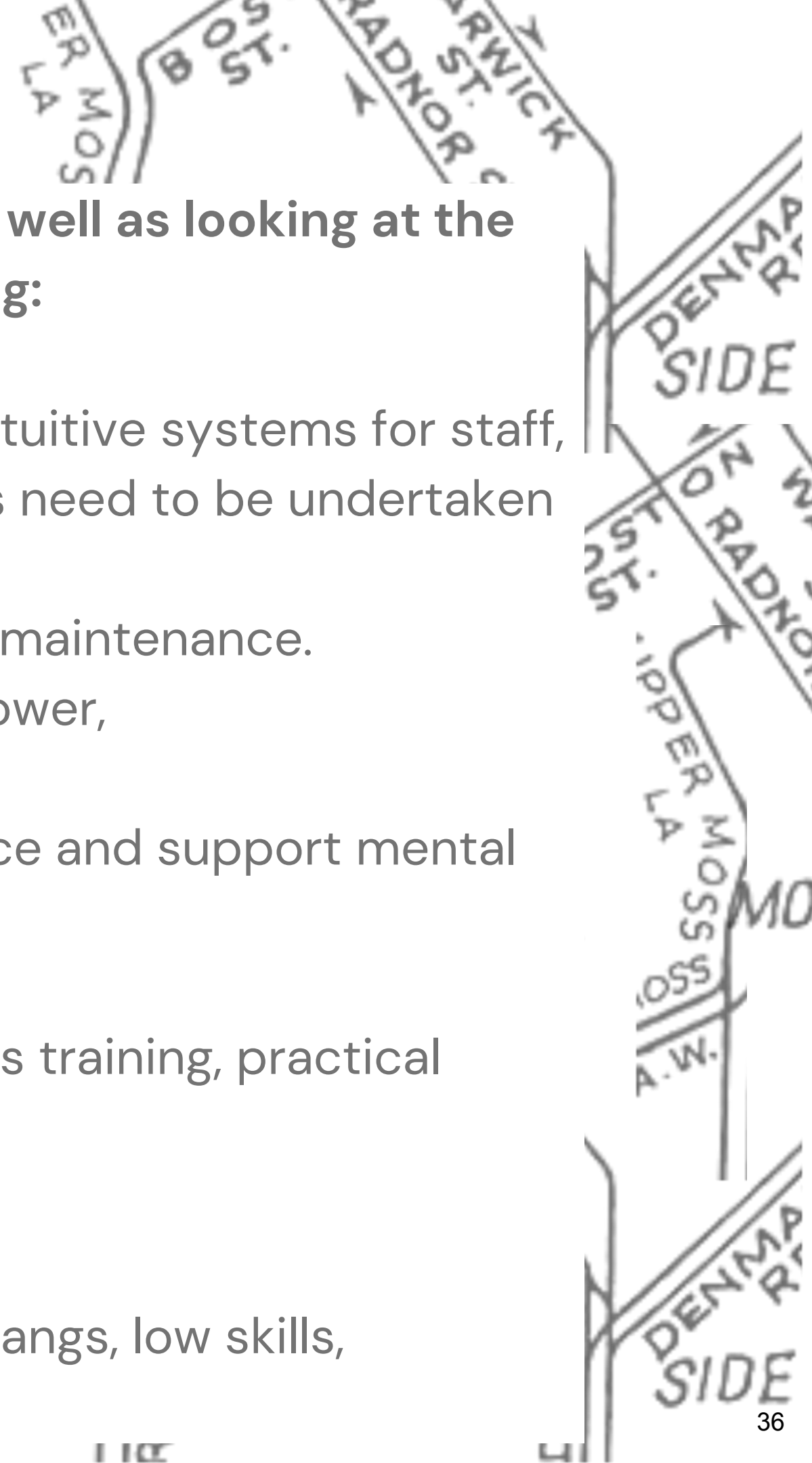

Don't want	Do want
Commercial / housing/ student accommodation	A fully accessible space
Non creative scheme, needs to keep love of the creative element	A fully integrated space – connecting the two venues
NIAMOS not to be part of the future development of the building	Focused on local communities creative and cultural interests
	Explore joint programming /projects
	To sit around the table with an organisation who equally has the needs of the local communities at heart, and discuss the future of the whole building

“Needs to be fit for a purpose and unfit for no purpose.” Co-Director, NIAMOS



Manchester Youth Justice Service Conversations

This was undertaken via emails and phone calls and centred on 4 areas:

- What unique offerings could the new Hippodrome provide to young people and the wider community that aren't currently available in Hulme?
- What creative and cultural services should the Hippodrome offer young people?
- How could a redeveloped Hippodrome help meet their goals and priorities?
- Are they interested in collaborating with SHH to develop and deliver co-produced, community-led programming?

The Head of Youth Justice Services gave a resounding yes to future involvement with SHH and the future of the Hippodrome.

Expressing a strong support for fostering young people's creative potential, aligning with the Service's child-first ethos, and promoting cultural participation. He emphasised the importance of early intervention with families and young people facing complex needs and financial instability. He suggested focusing on identity, belonging, and celebrating diverse cultures.

He also advocated for increased access to creative professions for working-class youth, particularly those with complex needs in local areas. He stressed the need for local representation on the board, including training and covering expenses for local young people.

“I would like to discuss the potential of basing an interactive support programme at the venue, in particular a programme working with and for children/young people who are victims of crime. This could be developed with our partners REMEDI (a charity which provide restorative justice).”

“I would like to see creative spaces for local young people, where they can learn new skills, feel safe, work with trusted adults, a crucial element for young people within the youth justice system.

“Knowledge can build respect and responsibility into their futures.”



Thomas Lang
Head of Service, Manchester Youth Justice



Team Around the Neighbourhood Conversations

The Hulme, Moss Side and Rusholme Neighbourhood Team Co-ordinator and Hulme based officer discussed very similar areas. They wanted space allocated

- to deliver training programmes
- for performances and events
- can be hired out for community activities
- meeting spaces for groups, arts-based SMEs and hyper local VCSE groups.
- a space to have a food offer like “the Bread and Butter thing” (food pantry service – <http://www.breadandbutterthing.org>)

Both felt that a newly developed venue could assist them in meeting their main goals of; **improving the quality of life and the environment with and for people who live, work study and play in Hulme.** This crucially includes community safety and health and wellbeing.

It could also be central to enhancing the communication network of groups/ organisations working in Hulme, developing more connected communities, regardless of religion, cultural and heritage backgrounds. The redesign of the building needs to lend itself to a range of initiatives and activities /projects and be fully accessible not just sensory and physical but economically and intellectually.

Team Around the Neighbourhood (TAN) Conversations

They did state that in the confines and scope of their roles they would like to assist the SHH campaign in the redevelopment of what could be an incredible local hub and asset.

Another member of the Team was keen to explore with the SHH Board/Campaign the potential of the technical specification of the building particularly with gaming in mind. He feels this would be a huge attraction for local young people and could be a way of bringing groups of young people together to develop understanding and awareness of each other.

“We would be keen to be part of a community led development where communication and collaboration with local people is the driving force”.

“Transformation of a derelict building - restoring it to its former glory and continuing its part in the sense of place in Hulme.”



Save

Hulme

Hippodrome

4. Findings

It was unanimously agreed that the building should be saved.

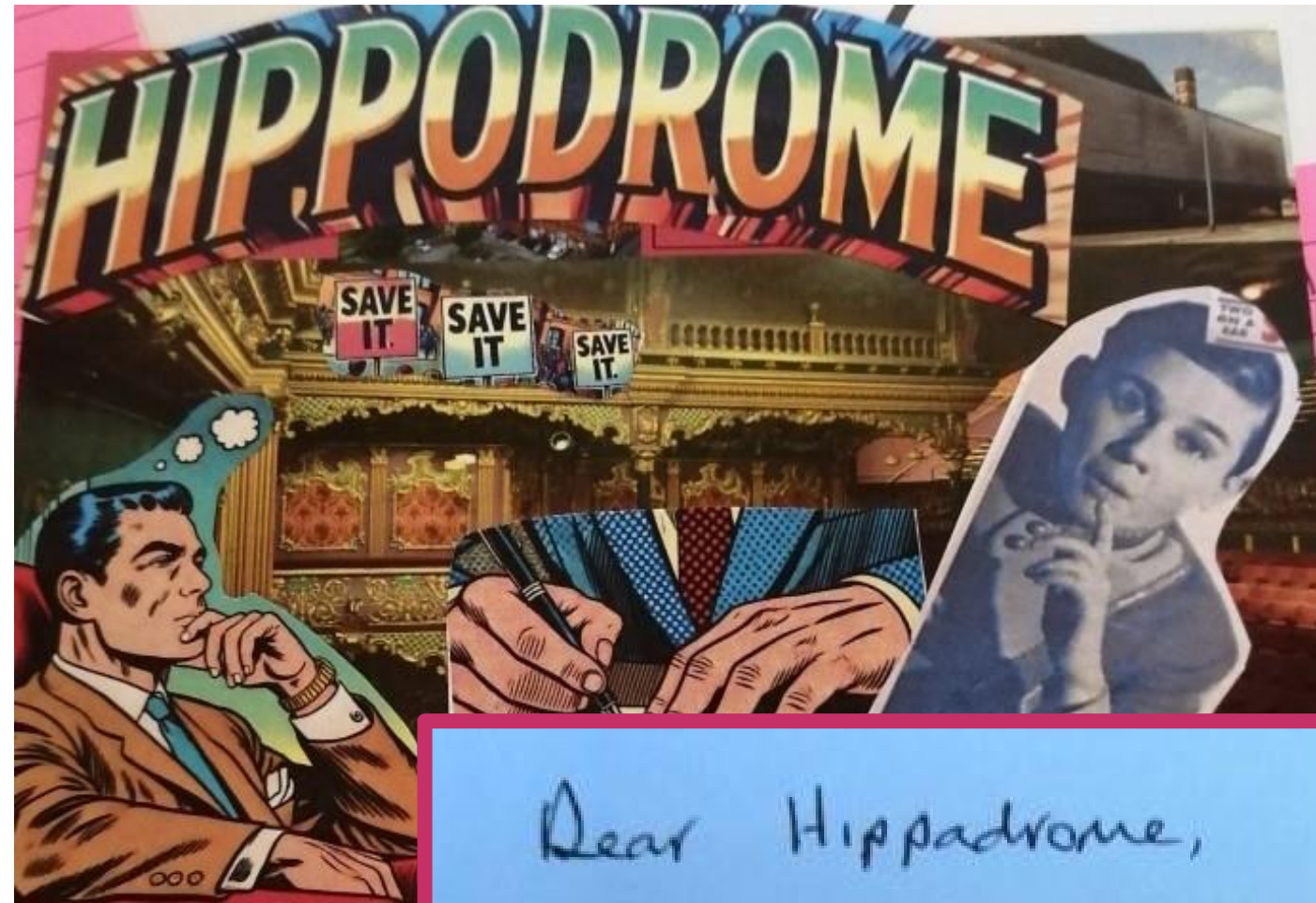

*Tenant's Group
Hippodrome
postcard*

The consensus was clear: the building should be saved, renovated, and developed for local communities, while retaining an element of creative and live performance.

There is a keenness for it to become a cultural hub run by and for the local people of Hulme and the surrounding areas.

Not one person wanted to see it demolished or used for commercial or housing ventures.

Dear Hippodrome,
I did not know you existed until recently when I researched your history. We need to keep this building alive so many more people from the community can enjoy this beautiful building and have a safe space where they can come together and have fun. Love Janet.

Findings

Many people felt it would be an excellent venue to provide a safe, welcoming and supportive space for local young people. A place where different groups could meet, share, develop new skills and assist in the production of events and live performances.

The reopening the Hippodrome was also seen as a way to reduce anti-social behaviour in the area.

It was suggested by a number of people that it should include spaces for hyper local services and start up studios and businesses set up by local people.

Affordability and access for local working class people, was seen as key. A few local venues were mentioned, where it was perceived 'they weren't for the likes of them' and the prices were unaffordable.

It is important for SHH to continue to consider and respect NIAMOS' radical and disruptive ideals and ethos. This report will hopefully be the start of a more collaborative relationship. Both want a sustainable future and to deliver co-produced activities and services with the full ranges of communities living and growing up in the area.

Findings (continued)

Throughout all the sessions, participants expressed how much they enjoyed and appreciated being invited to contribute.

They felt their voices were heard and wanted to stay connected to the project. Many showed interest in volunteering in the future, and those with stories about the Hippodrome were eager to share them.

The provision of refreshments, snacks, and thank-you bags, combined with the informal and interactive nature of the sessions, created a warm and welcoming atmosphere. This encouraged open and honest conversations about the SHH campaign and how it should closely reflect the needs and values of the working-class people who live and grow up in the area.

The timeframe and effort needed to arrange and confirm sessions should not be underestimated. This consultation was carried out by someone with strong local connections and experience in community engagement and it took many weeks longer than expected to secure and deliver sessions.

This project has just scratched the surface on building relationships with local organisations and exploring future partnerships.

Maintaining momentum is key to capitalising on the success of this consultation in raising awareness, making contacts, and generating interest.

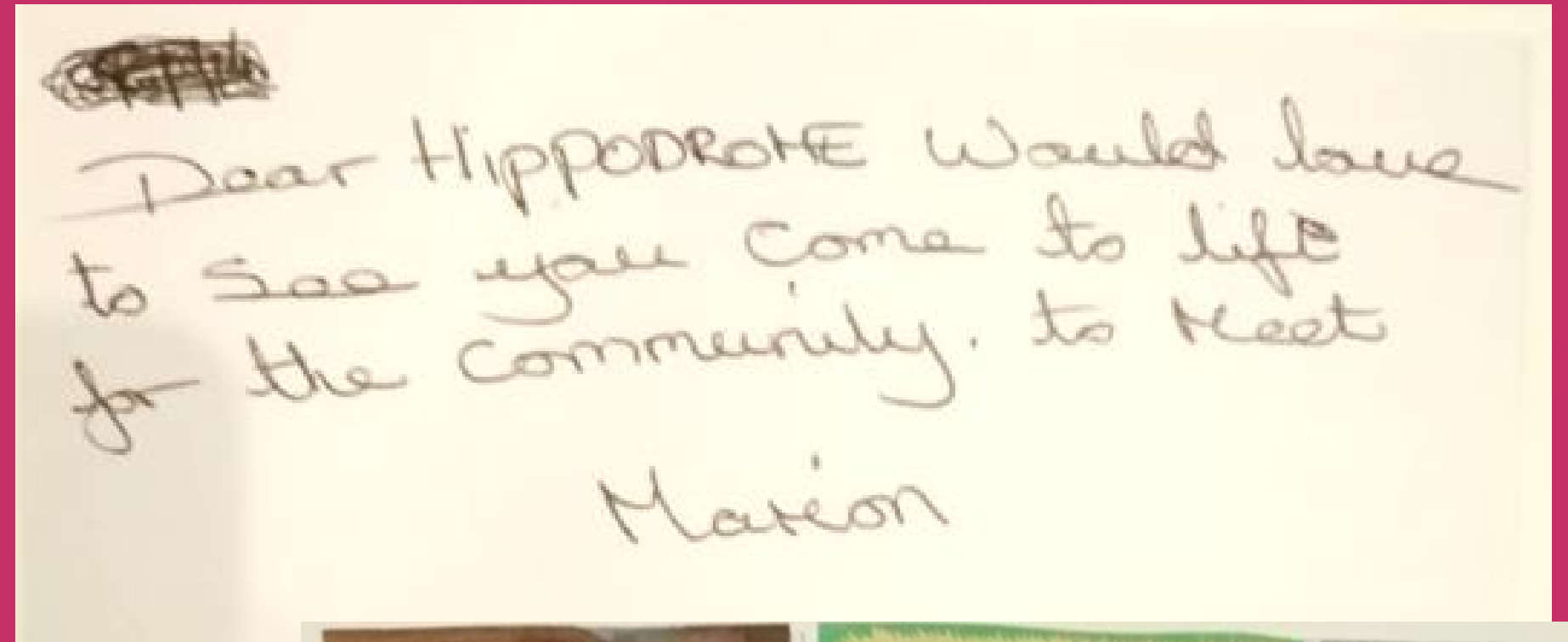
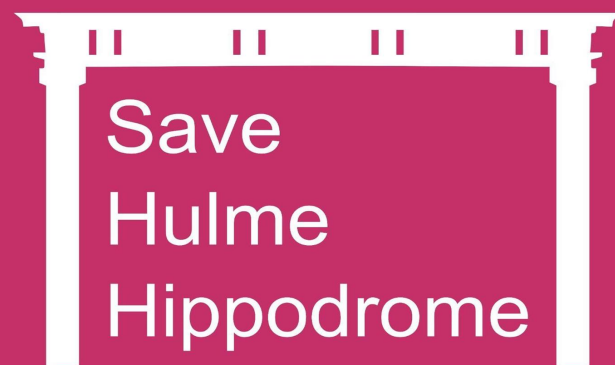

Tenant's Group participant



Save

Hulme

Hippodrome

5. Next Steps

Next Steps

A key priority is to share the report with NIAMOS.

As an aid to facilitate discussion on:

- the needs and hopes of Hulme residents,
- the respective goals and aims of each organisation
- opportunities to collaborate, as this may gain more traction with hyper local organisations and projects which are serving under represented groups.

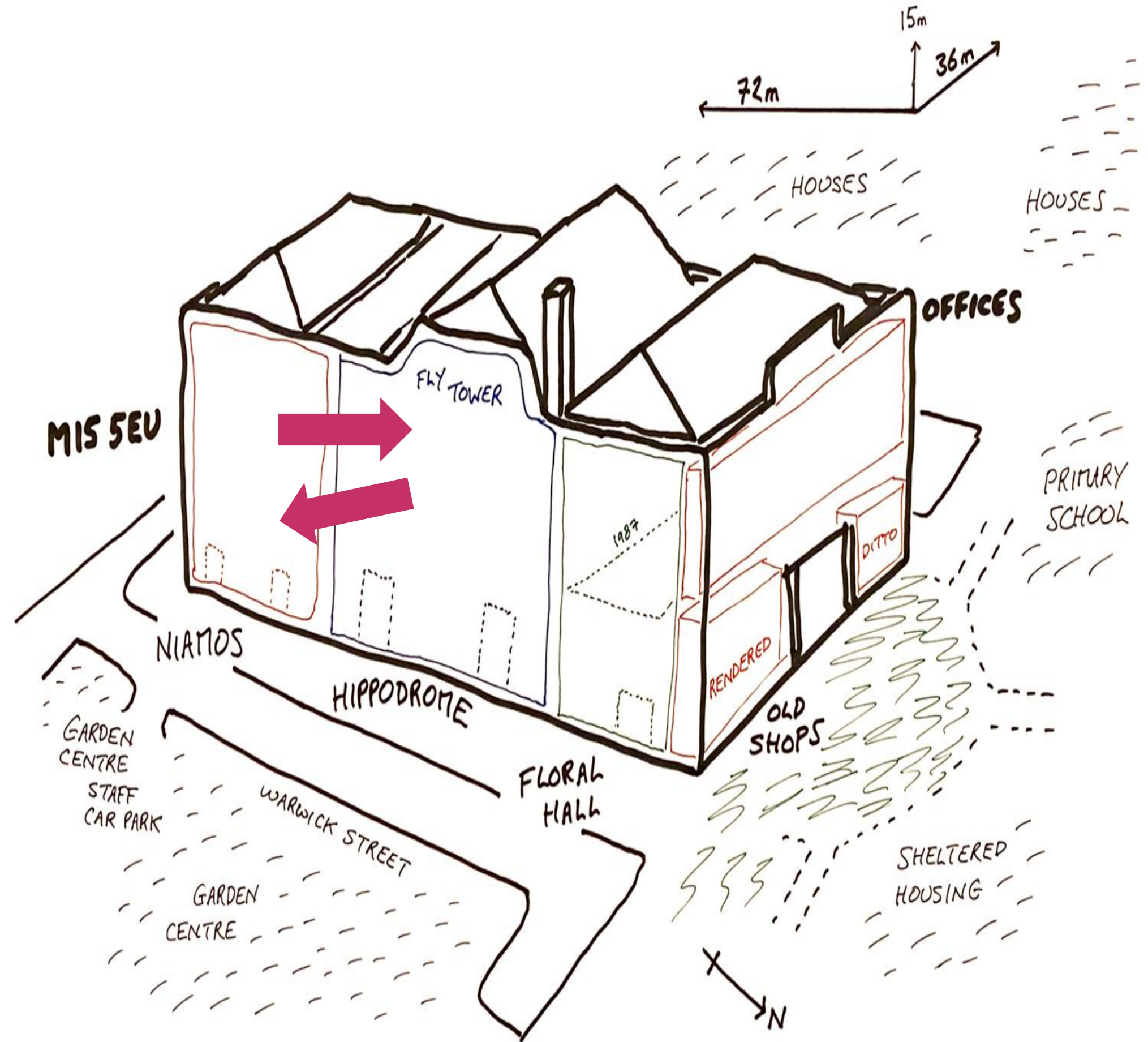

Next Steps

Continue the
conversations

- Disseminate the findings and report to all individuals and groups involved so far.
- Explore opportunities to display new resources in local community venues, to continue and open up new conversations.
- Review and revise the questionnaires to improve clarity and effectiveness. Add updated questionnaires to the SHH website and e-bulletin in a user-friendly format, such as Google Forms



Continue the consultation process by reaching out to local community groups and organisations working within the local area, that have not yet been engaged by SHH.

Next Steps

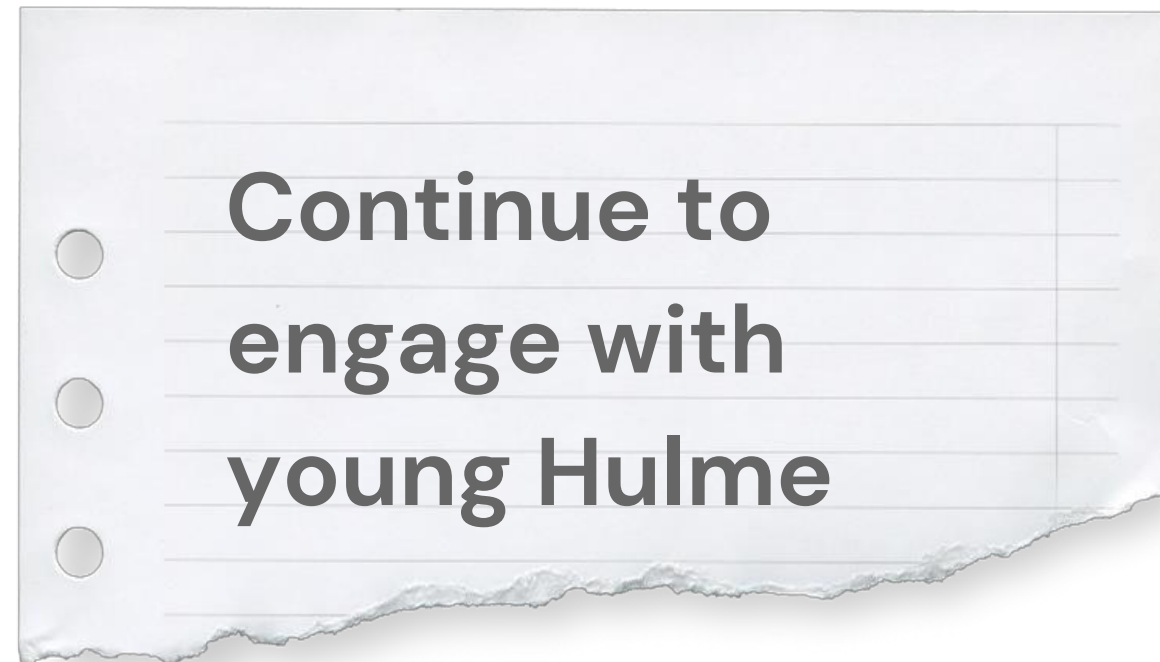

- Continue working with Rolls Crescent Primary school, with the aim to widen out to other schools in the local area.
- Explore with young people led organisations in the area such as Rekindle School and Youth Justice Service who could be interested in piloting/trialling ideas and projects as the Hippodrome development progresses.

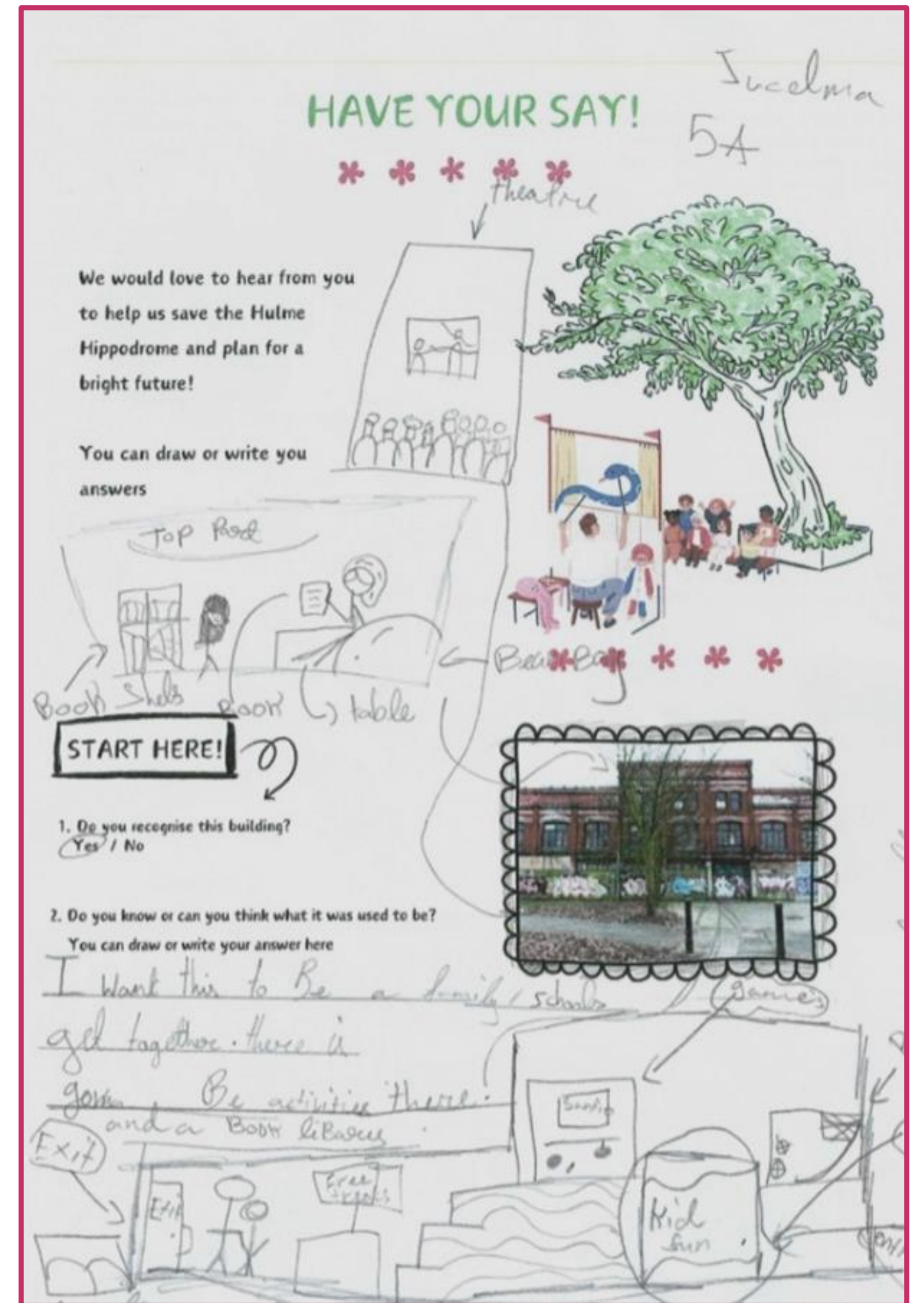

Next Steps

Focus on local partners

- Follow up on contacts who are keen to get involved but couldn't take part in this initial consultation; in particular Venture Arts. These close neighbours are an award-winning visual arts organisation working with learning disabled artists.
- Explore the potential of the Hippodrome becoming key partners in newly developing learning and skills programmes, such as the Manchester Baccalaureate, announced in July 2024.

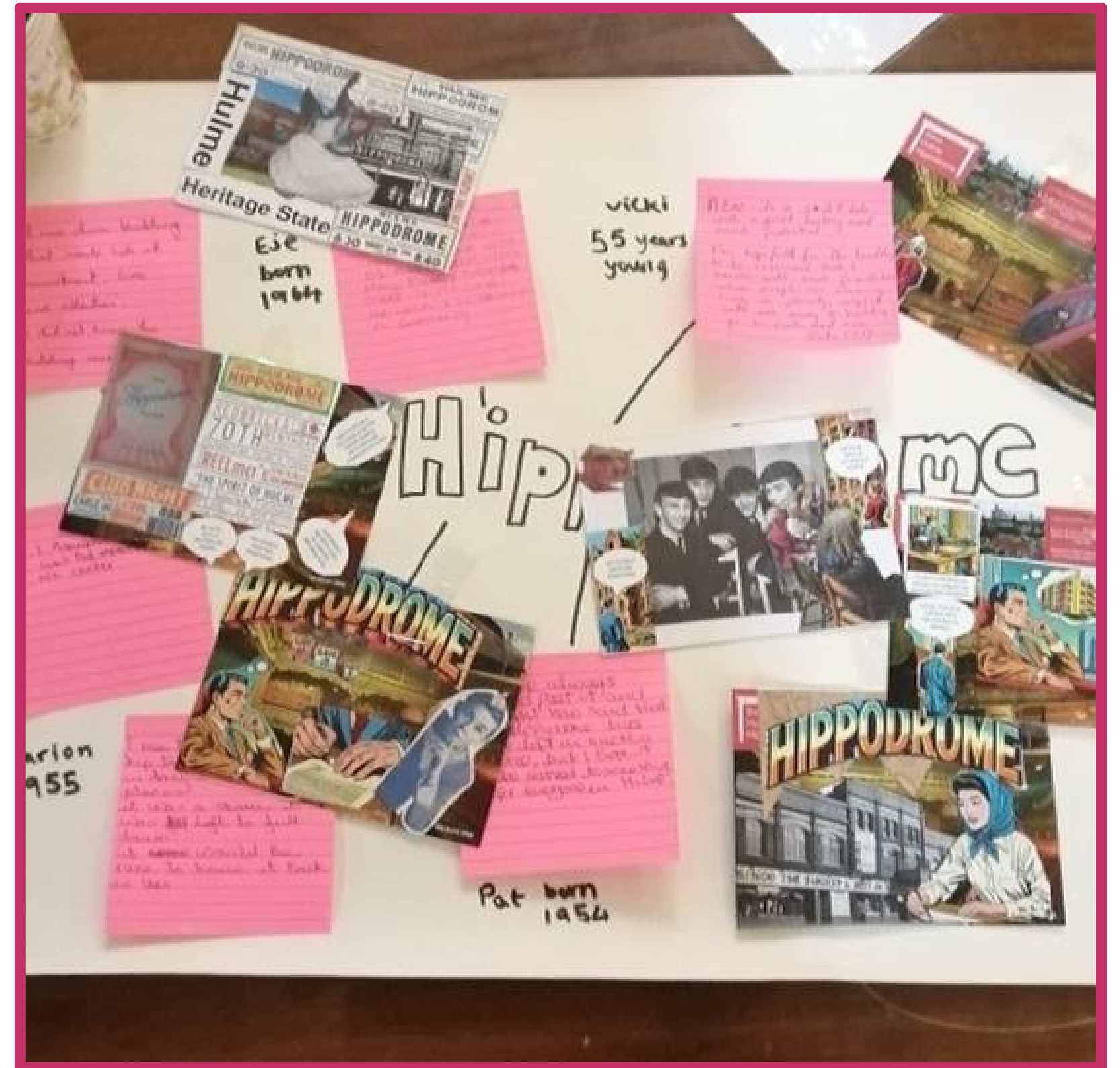

Exploring future opportunities

A database has been produced for SHH which includes

- contacts of organisations who took part in the project
- participants details, including;
 - contact details
 - interest in being kept up to date
 - potential volunteering
 - personal stories to tell of the Hippodrome
- contacts to follow up on who are interested but couldn't make the project timeframe
- further local contacts suggested by organisations and participants
- contacts of organisations innovating in community led cultural/creative venues.

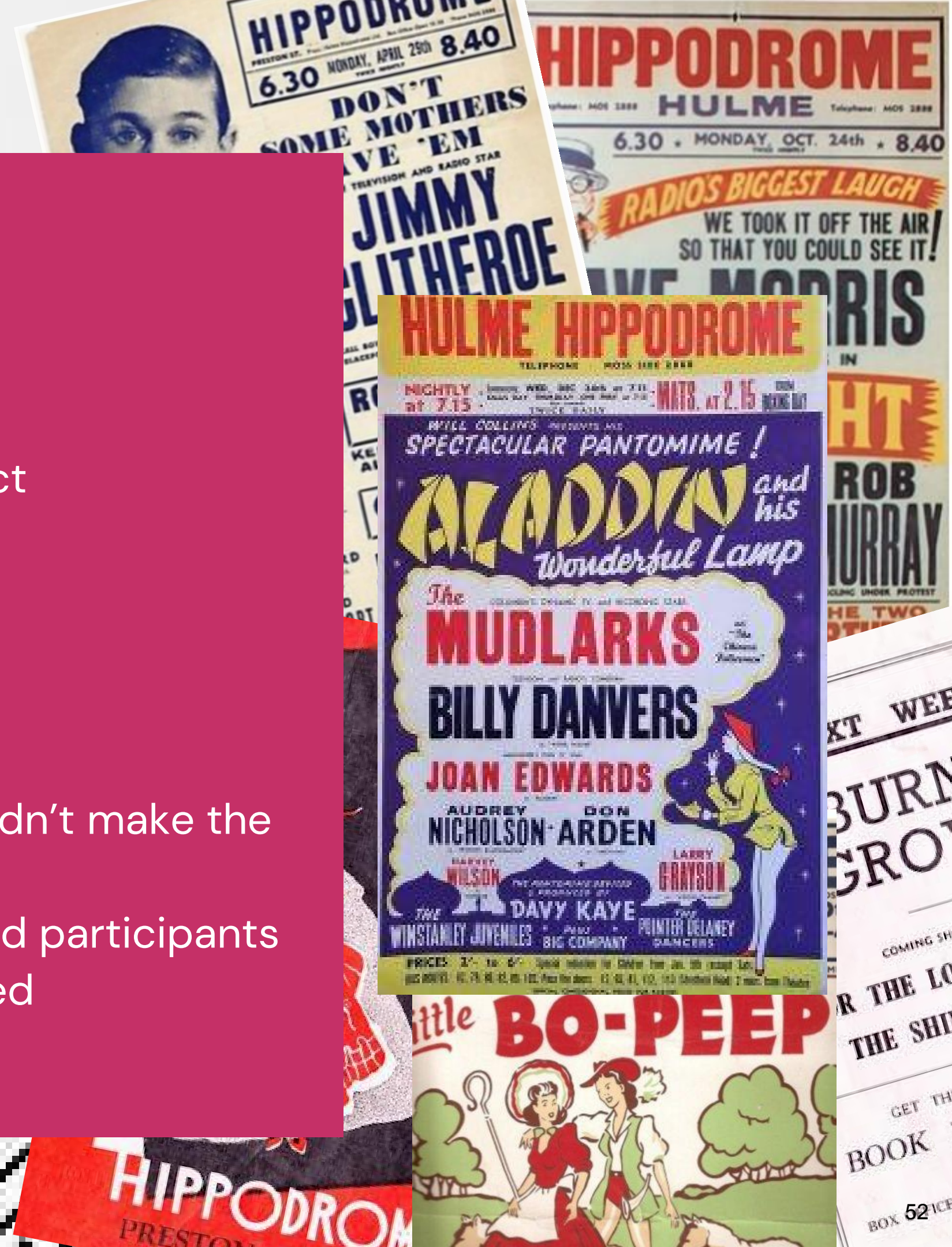

The last words go to the young Hulme residents, the potential audience, creators, performers and managers of the 21st Century Hulme Hippodrome

“An entertainment mall.”

“I would love to see the Hippodrome be a theatre and community centre”

“Draw and laugh, there’s lots to do, have the time of your life away from your strife!”

“Have clubs to learn, play, dance, perform and make art.”

“I would turn into a theme park, as now it is sulking like rotten tree bark!”

If I could design the Hippodrome I would:

I'd make sure it's not alone. It's not going to be rotten it makes it feel forgotten. I'll place an art room making it large, but don't worry it's free of charge. The abandoned will be known it makes it feel like home. Hippo's history is no longer a mystery. I hope my oration will unite our nation.

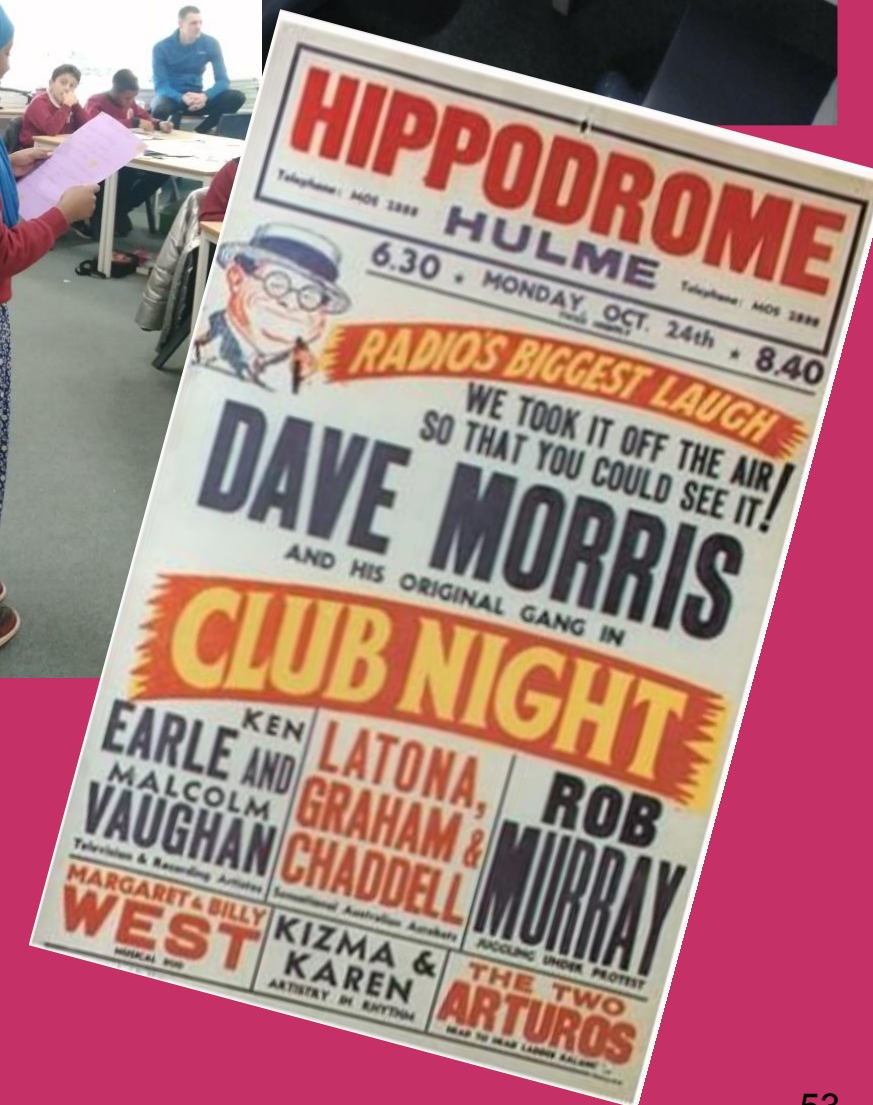

With Thanks...

To everyone who took part in this initial community consultation, and to Theatres Trust for making it possible.

Save Hulme Hippodrome Campaign Board

www.hulmehippodrome.org

Subscribe to the newsletter here

Save
Hulme
Hippodrome



Deb Walker
@dwconsultancy
dwalker14@btinternet.com



HULME HIPPODROME

NIGHTLY at 7.15

ALADDIN Wonderful

HULME HIPPODROME

6-30

RED RIDING HOOD

WAL BUTLER VERONICA RUSSELL

MARY MCGOWAN

HULME HIPPODROME

ROGER GARNE with CANABTA

COX TWINS

HIPPODROME COMMENCING MONDAY, DECEMBER 20th

little BO-PEE

HULME HIPPODROME

6.30 MONDAY, APRIL 29th 8.40

DON'T SOME MOTHERS 'AVE 'EM

JIMMY CLITHEROE

ROGER GARNE with CANABTA

KEN & ALAN HAYNES

COX TWINS

DAVE MORLEY

HULME HIPPODROME

TONY VAUGHAN

DY STREAM

GABRIELLE WEBER

10 LITTLE STARLETS 10 18 REGAL GIRLS

TRAINED LIVE SHEEP

JOHN CHILVERS BRYAN BRADLEY

SWAN & LEIGH

CLOWNS IN CLOVER

THREE BUFFOONS

HULME HIPPODROME

TERRY DENE AND HIS DENE-ACES

HULME HIPPODROME

6.30 MONDAY, OCT. 20th 8.40

BO-PEEP

HULME HIPPODROME

ALADDIN and his Wonderful Lamp

MUDLARKS

BILLY DANVERS

JOAN EDWARDS